

CORNER RECORD

Agency Index

BK 128 PG 12

Document Number

CR 13209

City of EDEN TOWNSHIP

County of ALAMEDA, California

Brief Legal Description MOST WESTERLY RAILROAD SPIKE MONUMENT LOCATED WITHIN
WESTERN BLVD AT SUNSET BLVD

CORNER TYPE

COORDINATES (Optional)

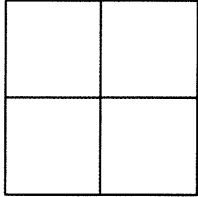

Government Corner ☐ Control ☒
Meander ☐ Property ☐
Rancho ☐ Other ☐

N. _____ E. _____

Elevation _____

Units Metric ☐ U.S. Survey Foot ☐

Horizontal Datum _____

Zone _____ Epoch Date _____

Vertical Datum _____

☐ Complies with Public Resources Code §§8801-8819☐ Complies with Public Resources Code §§8890-8902

Date of Survey 8/1/19

PLS Act Ref: ☐ 8765 (d) ☒ 8771 ☐ 8773 ☐ Other:

Corner/Monument: ☒ Left as found ☐ Established ☐ Rebuilt ☒ Pre-Construction
☐ Found and tagged ☐ Reestablished ☒ Referenced ☐ Post-Construction

Narrative of corner identified and monument as found, set, reset, replaced, or removed:

☐ See sheet #2 for description (s):

FOUND RAILROAD SPIKE WITH PUNCH
MONUMENT FOUND BELOW GRADE. EXCAVATED BEFORE REFERENCING.

FOUND AND SET POINTS AS SHOWN ON PAGE 2.

THIS POINT WAS REFERENCED PRIOR TO A CONSTRUCTION PROJECT IN THE VICINITY.

THE TIES SHOWN HEREON ARE FOR THE PURPOSE OF PERPETUATING FOUND MONUMENTATION.
NO CLAIM IS MADE AS TO THE RELATIONSHIP OF THE POINTS OR LINES SHOWN HEREON TO TRUE
BOUNDARY LOCATION.

SURVEYOR'S STATEMENT

This Corner Record was prepared by me or under my direction in conformance with

the Professional Land Surveyors' Act on AUGUST 5, 2019.

Signed SCOTT V. CUNHA P.L.S. or R.C.E. No. LS 8525

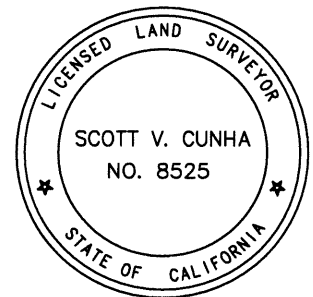

COUNTY SURVEYOR'S STATEMENT

This Corner Record was received AUG 07 2019,

and examined and filed NOV 18 2019.

Signed D. Ian Wilson P.L.S. or R.C.E. No. 7010

Title ALAMEDA COUNTY SURVEYOR

County Surveyor's Comment

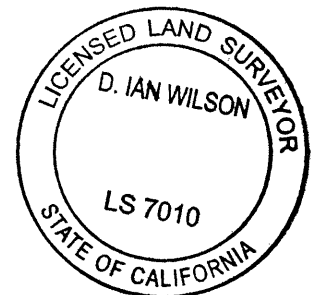

SPEC-2377-Pre

SCALE: 1"=30'

LEGEND

- △ FOUND RAILROAD SPIKE WITH PUNCH
- SET CUT CROSS IN WALK
- ✕ SET CUT CROSS IN CURB
- ✕ SET CUT CUT CROSS IN RAILROAD BAR
- SET REBAR & CAP STAMPED "CEI RP"

(19592) REFERENCE STREET ADDRESS

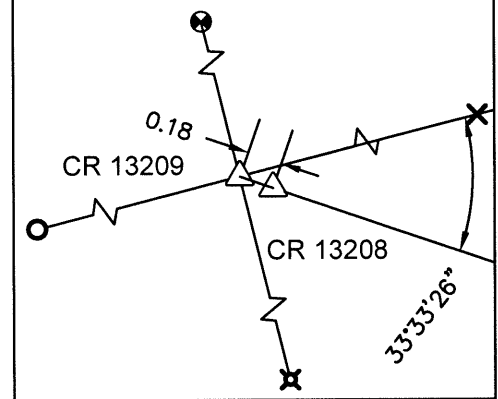

DETAIL BETWEEN RR SPIKES

