

# ANGEL INTERCEPTOR

## CARD MODEL

SCALE MODEL  
 PRINT-CUT-ASSEMBLE

ACTUAL MODEL

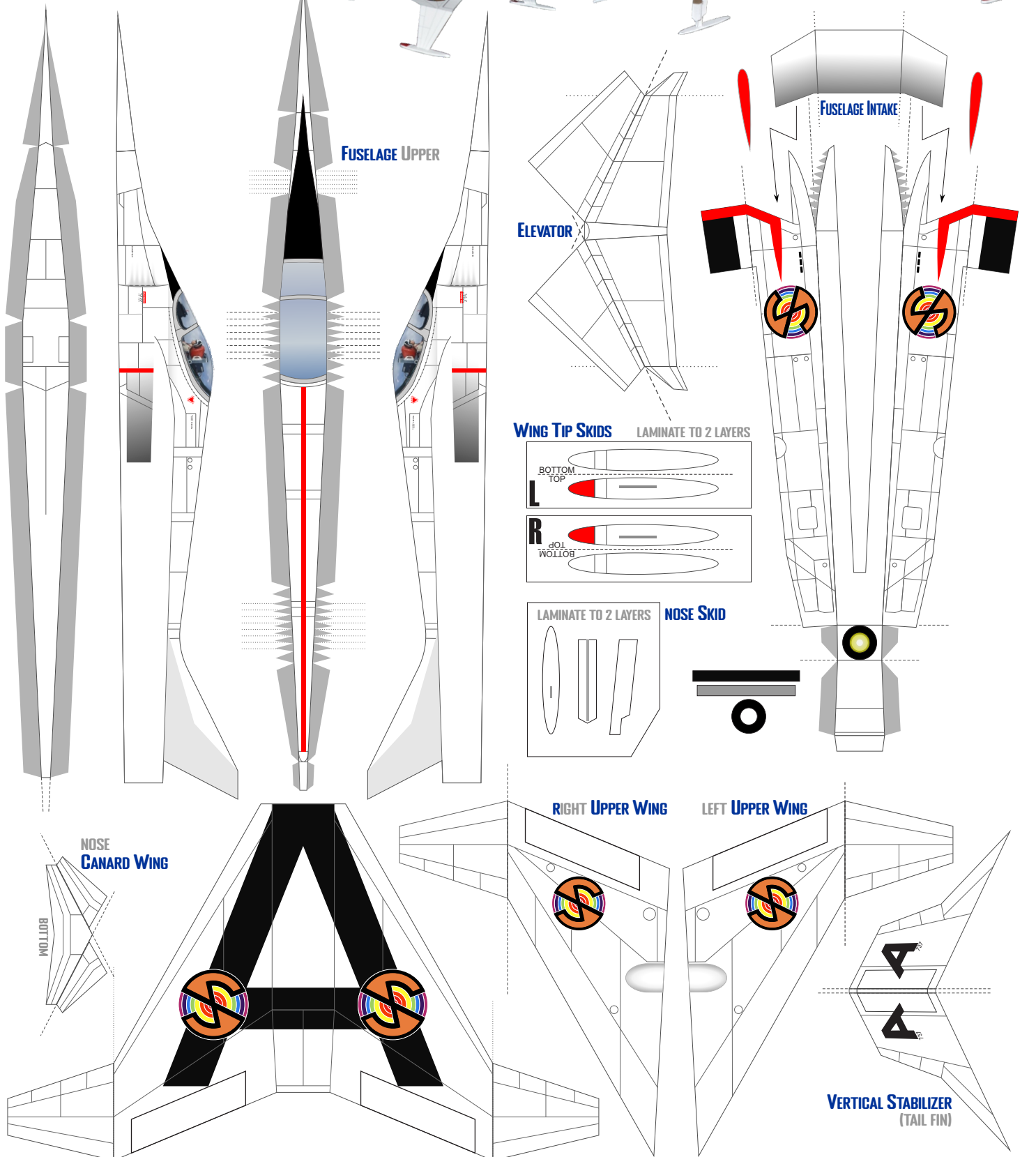

A GERRY ANDERSON PRODUCTION

# CAPTAIN SCARLET AND THE MYSTERONS

## ANGEL INTERCEPTOR

CARD MODEL

### SCALE MODEL ASSEMBLY



Koolwheelz models are my personal design challenge. They are meant to be simple, boxy and stylized, and are designed to have as few parts as possible. All parts should fit\* on one Letter size page. \*not including assembly instructions.

*Dave*

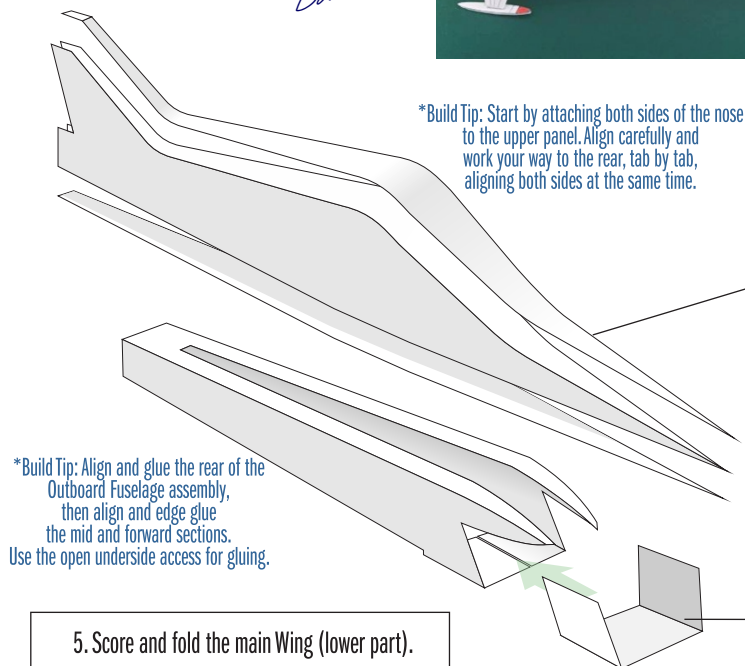

Prescore all Parts before cutting.  
Prefold parts before gluing.  
Test fit parts before assembly.

It is important to pre-shape parts to the correct shape before trying to glue parts together.

1. Assemble the central Fuselage. Shape and attach the top panel first (to the side panels).

\*Trim the nose if necessary once glued. Apply extra glue inside for strength.

2. Attach the lower panel to complete the central fuselage

3. Assemble the outboard Fuselage.

TIP: Assembly is a lot easier if you preshape the parts!

\*Install the inner Intake part to connect the lower seam of the Outboard Fuselage part.

4. Align and attach the Outboard Fuselage assembly to the central fuselage - carefully glue in place.

5. Score and fold the main Wing (lower part).

6. Score and fold the upper Wing panels and glue in place...make sure to align carefully!

7. Mount and glue the Wing assembly to the underside of the fuselage.

8. Score, fold and glue the Stabilizer to the rear of the fuselage.

9. Score, fold and glue the Elevator wing and mount to the top of the Stabilizer.

10. Assemble and install the engine exhaust outlet

Side fuselage details (laminated to two layers)

12. Score, fold and glue...then attach the Nose Canard wing.

11. Laminate to four layers and attach the Wing tip Skids.

13. Optional\* Assemble and attach the Nose Skid.  
\*not for in-flight display, the Nose Skid would be retracted.